



OPERATOR'S MANUAL AND PARTS LIST

BLOW VAC 2500 - QGBV2500

Spares & Support: 01793 333212

Before use please read & understand this manual, paying particular attention to the safety instructions.

Contents	
DIAGRAM	3
SAFETY INSTRUCTIONS	4
SPECIFICATIONS AND ELECTRICAL REQUIREMENTS	5
ASSEMBLING THE BLOWER/VAC	6
USING THE BLOWER/VAC	6
CARE AND MAINTENANCE	8
TROUBLE SHOOTING	7
PARTS DIAGRAM	8
PARTS LIST	9
EC DECLARATION OF CONFORMITY	10

DIAGRAM

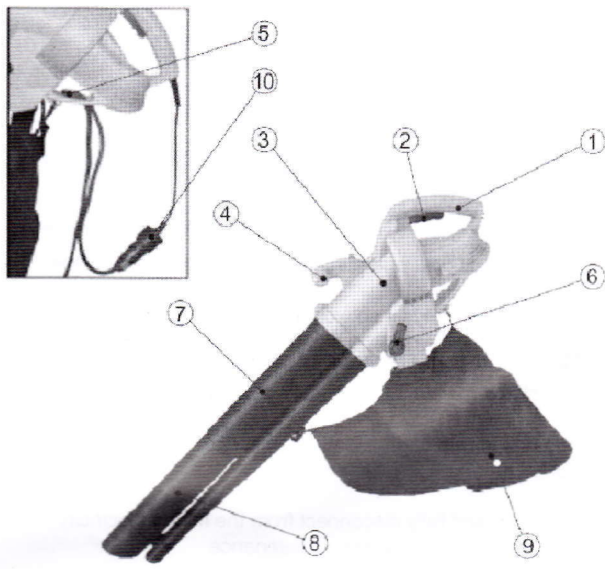

1	Rear Handle
2	On/Off Switch
3	Main Body
4	Front Handle
5	Cable Strain Relief
6	Changeover Switch
7	Top Suction Tube
8	Bottom Suction Tube
9	Collection Bag
10	Mains Cable

SAFETY INSTRUCTIONS

Read and understand the owner's manual and labels affixed to the electric blower/vacuum. Learn its application and limitations as well as the specific potential hazards. Retain these instructions for future reference.



- The Blow Vac is an electrical appliance using fast moving parts and as such can be dangerous if handled irresponsibly.
- The Blow Vac is only suitable for domestic use and can be used only for processing light, dry garden waste materials such as leaves, grass cuttings, clippings, small twigs and pieces of paper.
- **Never** use to vac, blow or shred heavy sharp or flammable materials such as metal, stones, branches, fir cones, glass, barbecue coals, cigarette ends, dust, gravel, soil or liquids.
- Use gloves and ear protection if operating for extended periods of time.
- We recommend eye protection is also worn during operation as objects can be ejected at high speed when the motor is running.
- Do not wear loose clothing, they may be sucked up by the Blow Vac.
- **Never** expose the unit to rain or moisture. Store the machine in a totally dry environment.
- **Always** turn off the unit and fully disconnect from the mains electricity supply when cleaning or performing any maintenance.
- **Never** insert your hands into the openings whilst the unit is running or connected to the mains electricity supply.
- Do **not** modify the unit in any way.
- Repairs can only be undertaken by our nominated customer service agents. See contact details on the rear cover of this manual.



SPECIFICATIONS AND ELECTRICAL REQUIREMENTS

Model	QGBV2500
Motor Power	2500W
Motor	AC - motor 230V - 50Hz
Speed n	14000 min ⁻¹
Blowing Air Flow (max air velocity)	270 km/h
Suction Power (max air velocity)	720m ³ /h
Hand/Arm Vibration (as EN 1033/DIN 45657)	Avhw= <3,96 m/s ²
Collection Bag Volume	35L
Protection Class	II – Double Insulated
Weight	Approx 4.5kg
Sound Power Level (as 2000/14/EG)	Measure sound power level 98.3dB(A)
	Guaranteed Sound Power Level 102 dB(A)
Sound Pressure Level LPA (as 2000/14/EG)	87dB(A)

The manufacturer reserves the right to change the product specification and livery according to continued product improvements.

ASSEMBLING THE BLOWER/VAC

1. Connect the top suction tube to the bottom suction tube and screw them together.
2. Insert both suction tubes into the main body and screw together.
3. Insert the front handle into the recess in the top of the main body.
4. Hook the front end of the collection bag onto the bottom suction tube, hook the rear end of the collection bag onto the main body and slip the square opening of the collection bag onto the square opening of the main body. It will snap into place.
5. Ensure the zip fastener is closed on the collection bag!
6. The strap is attached to the machine using the metal triangular clip. Unscrew and fix this to the small moulded ring on the top handle.
7. Thread the cable through the strain relief feature forming a loop as shown.
Ensure that there is sufficient slack in the cable.
8. It is recommended that a 30mA current safety cut-off switch is employed when using the Blow/Vac. Ensure the tubes are fixed in position and the collection bag is secure before connecting to the mains electricity supply.

The On/Off switch is located on the underside of the rear handle and is operated by pressing and holding the switch to turn On and releasing to turn Off.

Never use the Blow/Vac with wet hands or when it is raining.

Using as a Blower:

Move the switch to the blower setting as shown and move the Blow Vac gently from side to side a few centimetres above ground level.

Never point the Blow Vac at people or animals and take extra care when using near sand, soil, loose gravel or shingle.

To convert to a Vacuum Shredder:

Move the switch to the vac/shredder setting as shown.

Adjust the length of the shoulder strap to suit and hold the machine with both hands (one on the top handle, one on the rear handle).

Switch on and move the machine over the debris slowly.

Suction power decreases when the bag is full so ensure that it is emptied regularly.

Before emptying disconnect the Blow Vac from the mains.

When you have finished your work vacuuming return the switch to the blow mode to remove any material still lodged in the suction tubes.



CARE AND MAINTENANCE

Before you perform any cleaning or maintenance work on your Blow Vac, ensure that the unit is switched off, disconnected from the mains electricity supply and that all moving parts are stationary.

1. Remove dust and dirt with a cloth or brush.
2. Never use water or solvents to clean the unit.
3. Shake out the collection bag thoroughly, turn inside out and brush the bag out.
4. You may wash the bag by hand when it is very soiled using a mild detergent but ensure it is thoroughly dry before re-use.
5. If the zip becomes stiff to use, rub with dry soap.
6. Regularly check the bag for rips, tears and holes and replace immediately if damaged.
7. Store in a dry environment and ensure the unit is thoroughly clean prior to an extended storage time.

TROUBLE SHOOTING

Problem	Possible Cause	Remedy
Will not start	No mains power (Power failure) Motor or Switch Defect	Check the fuse Have a qualified electrician replace the cable if it is damaged Contact the helpline number on the rear cover of this manual
Material is not being vacuumed properly. Reduced vacuuming power.	Suction tubes clogged or blocked The collection bag is full Extension cable, if used, is too long or the cable cross section is too small.	Switch to blow mode and operate to clear the blockage. Empty the collection bag. Use the correct cross section size extension cable.

PARTS DIAGRAM

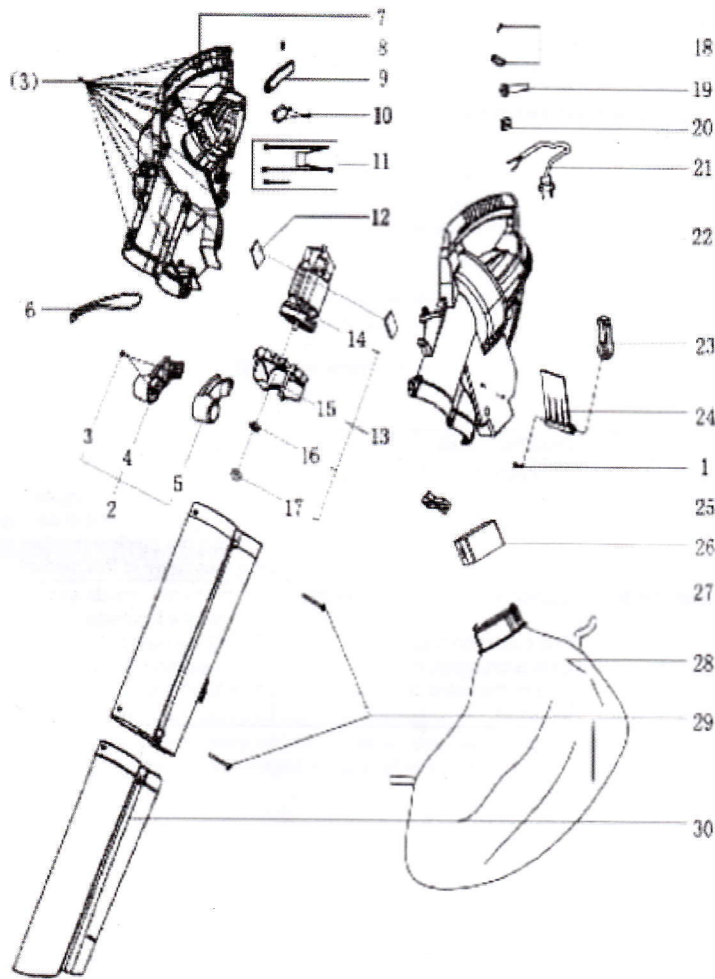

PARTS LIST

No.	Part No.	Description	Qty
1	TH100-1	Screw	4
2	QG101-2	Front Handle Assembly	1
3	TH100-3	Screw	23
4	QG101-4	Right Part of Front Handle	1
5	QG101-5	Left Part of Front Handle	1
6	TH100-6	Carry Strap	1
7	QG101-7	Right Main Housing	1
8	TH100-8	Spring	1
9	TH100-9	On/Off Button	1
10	TH100-10	Switch	1
11	TH100-11	Capacitor	1
12	TH100-12	Rubber Gasket	2
13	TH100-13	Motor Sub Assembly	1
14	TH100-14	Motor	1
15	TH100-15	Fan	1
16	TH100-16	Lock Nut	1
17	TH100-17	Insulated Cap	1
18	TH100-18	Cord Clamp	1
19	TH100-19	Cord Guard	1
20	TH100-20	Terminal Block	1
21	TH100-21	Power Cable	1
22	QG101-22	Left Main Housing	1
23	TH100-23	Vac/Blow Lever	1
24	TH100-24	Air Block Board	1
25	TH100-25	Board	1
26	TH100-26	Bush	1
27	TH100-27	Top Suction Tube	1
28	QG101-28	Collection Bag	1
29	TH100-29	Screw	1
30	TH100-30	Bottom Suction Tube	1

EC DECLARATION OF CONFORMITY

Declaration of conformity

Pursuant to the regulations of the following EC Directives:

- 98/37/EC
- 2006/95/EC
- 2004/108/EC
- 2000/14/EC as amended by 2005/88/EC

Handy Distribution Ltd hereby declares that the product:

Machine type: 2500W Leaf Blower/Vacuum

Machine model: QGBV2500

Mass in kg: 4.0kg

Speed: 14000/min

Net Installed Power: 2500W

Conforms to the main safety requirements of the EC Directives listed above.

This conformity is based on the following standards and normative documents:

- EN60335-1/A2:2006+A13: 2008
- IEC60335-2-100: 2002
- PrEN15503: 2006
- EN62233: 2008
- EK9 2007-07:200611-16
- EN55015-1: 2006
- EN55015-2:1997 / A1: 2001
- EN61000-3-2: 2006
- EN61000-3-3 /A2: 2005

The conformity assessment procedure followed was in accordance with Annex III of the Directive 2000/14/EC as amended by 2005/88/EC

Measured Sound Power Level: 101.1dB (A)

Guaranteed Sound Power Level: 102dB (A)

The responsible person, based within the EC, is identified below

Name: Mr. Simon Belcher

Title: Managing Director

Company: Handy Distribution Ltd

Address: Hobley Drive, Stratton St Margaret, Swindon, Wiltshire, SN3 4NS

Signature :



Date: 15th June 2011

Spares & Support: 01793 333212

